

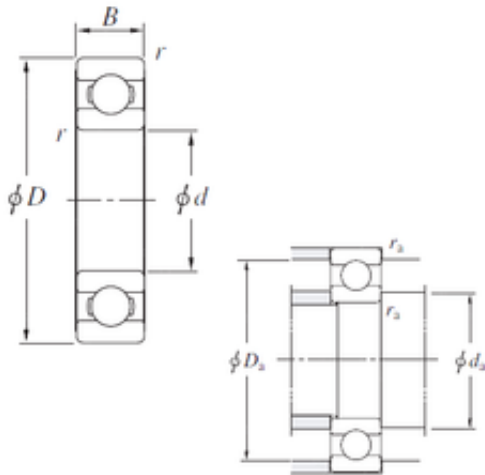

Genuine Pump Valve CO., LTD.



6024 KOYO Single-row deep groove ball bearings

Bearing No. 6024

6024 Bearing 2D drawings and 3D CAD models

Size	120x180x28 mm
Bore Diameter	120 mm
Outer Diameter	180 mm
Width	28 mm
d	120 mm
D	180 mm
B	28 mm
C	28 mm
r min.	2 mm
da min.	129 mm
Da max.	171 mm
ra max.	2 mm
Weight	2,07 Kg
Basic dynamic load rating (C)	85 kN
Basic static load rating (C0)	79,3 kN
(Grease) Lubrication Speed	3600 r/min
(Oil) Lubrication Speed	4200 r/min
Category	Single Row Ball Bearings
Inventory	0.0
Manufacturer Name	KOYO
Minimum Buy Quantity	N/A
Weight / Kilogram	2.281
Product Group	B00308
Enclosure	Open
Precision Class	ABEC 1 ISO P0



Genuine Pump Valve CO., LTD.

Maximum Capacity / Filling Slot	No
Rolling Element	Ball Bearing
Snap Ring	No
Internal Special Features	No
Cage Material	Steel
Internal Clearance	C0-Medium
Inch - Metric	Metric
Long Description	120MM Bore; 180MM Outside Diameter; 28MM Outer Race Diameter; Open; Ball Bearing; ABEC 1 ISO P0; No Filling Slot; No Snap Ring; No Internal Special Features
Category	Single Row Ball Bearing
UNSPSC	31171504
Harmonized Tariff Code	8482.10.50.68
Noun	Bearing
Keyword String	Ball
Manufacturer URL	http://www.koyousa.com
Manufacturer Item Number	6024
Weight / LBS	5.024
Bore	4.724 Inch 120 Millimeter
Outside Diameter	7.087 Inch 180 Millimeter
Outer Race Width	1.102 Inch 28 Millimeter
Bearing No.	6024
r(min)	2
Cr	106
C0r	79.3
Cu	3.60
f0	15.9
Grease lub.	3600
Oil lub.	4200



Genuine Pump Valve CO., LTD.

da(min)	129
Da(max)	171
ra(max)	2
(Refer.)Mass(kg)	2.07